

File name \\UK.WSPGROUP.COM\CENTRAL DATA\PROJECTS\70079973--WIGAN COUNCIL MCF\03 WIP\CVI CIVIL ENGINEERING\02 DRAWING\9973-WSP-T5-1D-DR-C-0204A.DWG, printed on 21 February 2022 15:22:19, by Whiteley, Lewis

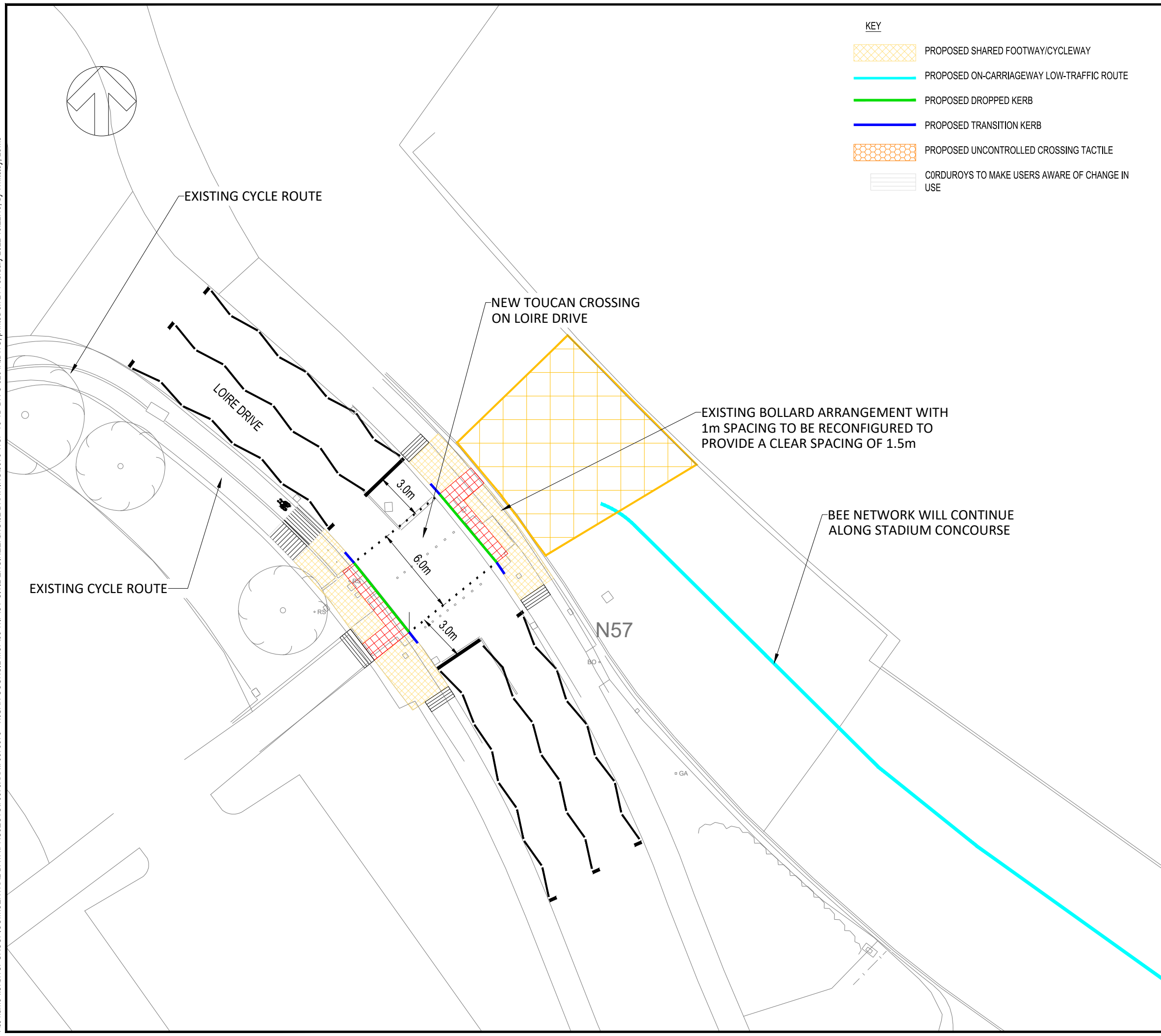

DO NOT SCALE

UNTIL TECHNICAL APPROVAL HAS BEEN OBTAINED FROM THE RELEVANT LOCAL AUTHORITIES OR STATUTORY BODIES, IT SHOULD BE UNDERSTOOD THAT ALL DRAWINGS ARE ISSUED AS PRELIMINARY AND NOT FOR CONSTRUCTION. SHOULD THE CONTRACTOR AND / OR EMPLOYER COMMENCE WORK PRIOR TO APPROVAL BEING GIVEN, IT IS ENTIRELY AT THEIR OWN RISK.

REV	DATE	BY	DESCRIPTION	CHK	APP
P08	17/02/2022	LW	NOTE AND CYCLE SYMBOL ADDED	MC	JB
P07	09/02/2022	LW	NOTES AMENDED	MC	JB
P06	24/01/2022	LW	SIGNALIZED PEDESTRIAN CROSSING AMENDMENT	MC	MB
P05	09/12/2021	LW	YELLOW BOX MARKING AMENDED	MB	MB
P04	09/11/2021	DR	AMENDMENTS TO SUIT CLIENT COMMENTS	JXB	SM
P03	24/09/2021	JB	TOUCAN AND DW STADIUM LOW-TRAFFIC ROUTE	JXB	SM
P02	17/09/2021	EJ	YELLOW HATCH BOX ADDED	JXB	SM

DRAWING STATUS:

8 First Street, Manchester, M15 4GU, UK
T+ 44 (0) 161 200 5000
wsp.com

CLIENT: **Wigan Council**

ARCHITECT: N/A

PROJECT: WIGAN MCF

TITLE: LEEDS & LIVERPOOL CANAL TO ROBIN PARK CYCLING & WALKING ROUTE CROSSING DETAIL 6 - LOIRE DRIVE

SCALE @ A3: 1:250 CHECKED: JXB APPROVED: SM

PROJECT No: 70079973 DESIGNED: JTB DRAWN: JTB DATE: February 22

DRAWING No: 9973-WSP-T5-1D-DR-C-0204A REV: P08