



Report to: Children, Young People and Families Scrutiny
Committee
Cabinet

Date: 11 March 2010
18 March 2010

Subject: Proposal to Enlarge Lowton Junior and Infant School

Report of: Executive Director Children and Young People's
Services

Contact officer: Sue Wilkinson 01942 486238
sue.wilkinson@wigan.gov.uk
Chris Parry 01942 486029
c.parry@wigan.gov.uk

Purpose / summary: The purpose of this report is to:

- ◆ Inform members of the response to the statutory notice containing the proposal to enlarge Lowton J+I School; and
- ◆ Request that Cabinet determines the proposal.

Alternative options considered and reason for selecting the one recommended: These were contained within the previous Cabinet reports on the proposal.

Recommendation / decision: It is recommended that Cabinet determines the proposal to enlarge Lowton J+I School by increasing the physical capacity of the school to 210 pupils so that the school admits 30 pupils in each year group.

Key Decision: This report involves a key decision within ground 2.

The decision made as a result of this report will be published within **48 hours** and cannot be actioned until **seven working days** have

elapsed, i.e. before 30 March 2010.

Under the relevant statutory provisions the Council must make a decision in relation to the proposal within a fixed timescale or it loses the right to make any decision and the issue is automatically referred to the Adjudicator. A call-in of the Cabinet decision could postpone the implementation of that decision beyond that time limit and in these circumstances the decision could be viewed as being urgent as it would seriously prejudice the Council's position. The consent of the Mayor that it is reasonable to treat the report as being urgent for these purposes is required and this consent is to be sought prior to the Cabinet meeting. It is of course the case that the report will in any event be considered by the relevant Scrutiny Committee in advance of the Cabinet meeting.

Risks / Implications:

Financial:	The capital costs of the project will be covered as part of the overall Building Schools for the Future cost envelope.
Staffing:	The school's budget will alter in line with pupil numbers contained within the Dedicated Schools Grant. The governing body will determine the staffing arrangements for the school in line with budgets and pupil numbers.
Policy:	Wigan's Strategy for School Places and Buildings
Equal Opportunities - Has a Diversity Impact Assessment been conducted?	Yes
Wards affected:	Lowton East

Property Implications – Does the proposal involve a reduction, addition or change to the Council's asset base or its occupation?

Yes

If yes, have the property implications been agreed with the Corporate Property Officer?

Yes

Does this proposal have significant implications for the Council and the local population?

A diversity impact assessment is not necessary at this stage, however, equality and diversity implications have been considered when producing this report.

Does this proposal involve a new policy or procedure or significant changes to an existing policy or procedure?

No.

Has the Service Director - Borough Solicitor confirmed that the recommendations within this report are lawful and comply with the Council's Constitution? **Yes**

Has the Service Director - Corporate Services confirmed that any expenditure referred to within this report is consistent with the Council's budget? **Yes**

Are any of the recommendations within this report contrary to the Policy Framework of the Council? **No**

For Cabinet reports only :

Categorisation of the report:			
Discussion leading to a decision	x	Discussion	
Monitoring		Decision	
Sharing for corporate understanding		Information	

Tracking/Process:

	Consultation	Ward Members	Partners
Committee	Overview & Scrutiny	Cabinet	Council
11/03/2010		18/03/2010	

List of Background Papers in accordance with Section 100D of the Local Government Act 1972:

Title of document	Which meeting did it go to?	Date of meeting	Copy available from?
Wigan's Strategy for School Places and Buildings			Children and Young People's Services Progress House Westwood Park Drive Wigan WN3 4HH

Proper Officer



Date

February 2010

1 Background

1.1 The following reports have previously been considered on proposals for Lowton J+I School:

1.2 30 July 2009 Cabinet

Cabinet determined that the proposals to close Lowton J+I and Leigh Gilded Hollins Primary Schools and to establish a new school on the Lowton Civic site should be withdrawn. Cabinet preferred, instead, to consult on a new proposal to enlarge Lowton J+I School to a full one form of entry primary school.

1.3 17 December 2009 Cabinet

Cabinet considered a report on the result of the stage 1 consultation on the proposal to enlarge Lowton J+I School and determined to proceed to stage 2 consultation – the publication of statutory notices.

1.4 A report to Children and Young People's Panel and Cabinet on 7 February 2008 and 6 March 2008 respectively sets out the Local Authority's powers in relation to decision making on school organisation proposals to expand a mainstream school, provided that it does so within two months of the end of the representation period. The report details the procedures and information that Cabinet must consider prior to taking its decision.

2 Publication of Notices and the Representation Period

2.1 On 14 January 2010 we published a statutory notice to enlarge Lowton J+I School by increasing the physical capacity from 119 to 210 pupils so that the school admits 30 children into each year group. A copy of the statutory notice is attached at Appendix A and the complete proposal with its appendices is attached at Appendix B.

2.2 The statutory representation period is four weeks. The Local Authority received two letters making comments on or objections to the proposal by the closing date of 11 February 2010 from:

- ◆ A local resident; and
- ◆ The governing body of Lowton St Mary's C E Primary School, Newton Road, Lowton, WA3 1EW (attached at Appendix C).

2.3 Comments from Local Resident

2.3.1 Lowton J+I should be extended on its current site.

Response: This consultation is on the proposal to enlarge Lowton J+I School only and not relocation of the school. School Organisation Regulations do not

require the Local Authority to consult on the relocation of the school as the proposed site is very close to the existing site.

2.3.2 Co-location with the proposed secondary school will cause traffic problems.

Response: This consultation is on the proposal to enlarge Lowton J+I School to one form of entry not on relocation of the school. Cabinet will consider the effects of any change in site when they consider the proposals for the new secondary school to replace Lowton and Golborne High Schools and the proposed new site and campus arrangement.

2.4 **Comments from the Governing Body of Lowton St Mary's C E Primary**

2.4.1 There is no need to enlarge Lowton J+I School as there are sufficient primary school places in Lowton.

Response: In September 2009 all reception class places in the Lowton area were full. Birth statistics suggest that this will continue for the foreseeable future. Trends over a number of years also show that more children enter reception class in the Lowton area than are born there.

Birth year	2004/05	2005/06	2006/07	2007/08	2008/09
Year enters reception	2009/10	2010/11	2011/12	2012/13	2013/14
No: of births	121	140	128	124	142

The provision of an additional 13 places per year group at Lowton J+I School will help ensure that primary school age children living in Lowton can access a school place locally.

It is correct that the proposed new secondary school for Lowton and Golborne has fewer places than the current two secondary schools together. However, this does not mean that fewer places are needed for children living in Lowton and Golborne. The current two secondary schools have a much wider catchment, admitting many pupils from Leigh and other neighbouring areas. Under the Building Schools for the Future proposals, these children will be provided for at other secondary schools.

2.4.2 The proposed new building for Lowton J+I school is large enough for 1.5 form entry. What is the reason for this?

Response: The notice and proposal state that the new capacity of the school will be 210. This is the correct size for a 1 form entry primary school as it allows for seven year groups with thirty pupils in each, giving a total number of 210 pupils across the school.

2.4.3 The governing body of Lowton St Mary's C E Primary School believe that the school was the preferred option to provide extended and community services for the area.

Response: The Local Authority operate the cluster model for extended services and would expect all schools to be able to offer access to extended services through the cluster arrangement.

2.4.4 There was no consultation with staff and governors and Lowton St Mary's C E Primary School.

Response: Stage 1 of the consultation on this proposal took place between 7 September 2009 and 23 October 2009. A consultation document was produced and distributed to all interested parties (full details are included in Appendix B). Twenty copies of the consultation document were sent to the headteacher at Lowton St Mary's C E Primary School on 7 September 2009, by internal mail, with a covering letter asking that one copy be given to the Chair of Governors and the remainder displayed in school where parents and staff members could see them.

The statutory notice and full proposal were published on 14 January 2010. Copies of these were sent to the school by e-mail, for the attention of the Headteacher and Chair of Governors on the date of publication.

2.4.5 Why is there a need for another Children's Centre in the area?

Response: The provision at Lowton St Mary's is not a children's centre, it is early years provision only. The Children's Centre at Lowton J+I School will be a phase 3 children's centre. Phase 3 children's centres do not need to have childcare on site and there is no proposal to put childcare on the Lowton J+I site. This is because we are aware of the provision at Lowton St Mary's C E Primary School and other providers and do not require additional places to meet the duty to supply sufficient childcare in this area.

3 Consideration of the Proposals

3.1 The following information must be considered before a decision is taken:

3.1.1 Has all the necessary information been provided?

Copies of the following have been provided:

- ◆ The public notice and full proposals;
- ◆ Details of the Stage 1 consultation which are contained within the full proposals and their appendices; and
- ◆ Details of the comments received.

3.1.2 Does the published notice comply with statutory requirements?

The Local Authority consulted the Department for Children, Schools and Families (DCSF) and Wigan Council Business Support Services – Legal and Democratic Division prior to publication to ensure that the notice complied with statutory requirements.

3.1.3 Has statutory consultation been carried out prior to the publication of the notice?

The full proposals attached at Appendix B cover the stage 1 consultation in detail.

3.1.4 Are the proposals linked to other proposals?

The proposal to enlarge Lowton J+I School is not linked to any other proposals.

3.2 Further Considerations

3.2.1 How the proposal will impact on local diversity and the expansion of popular and successful schools

Lowton J+I will be one of only a few primary schools co-located with a secondary school and extended services in the authority. The new secondary school will not be a community school and its management arrangements may offer the opportunity for formal collaborative management arrangements with Lowton J+I. Each year, the school receives first preferences at or around its admission number but some year groups have numbers on roll in excess of the admission number, including the current Reception year.

3.2.2 The effect on educational standards and school improvement

The school was inspected in February 2009. OFSTED graded the school as satisfactory and many outcomes were good. The curriculum is good and improving.

3.2.3 How the proposals will help every young person to achieve their potential within Every Child Matters principles, for example, through extended school provision

Lowton J+I will be co-located with the new secondary school on a site that will have additional community facilities and access to referral services. It will be ideally placed to offer a full range of extended services to its pupils and the co-location will aid transition and educational outcomes.

3.2.4 The need for additional places

In 2009, every available reception class place was filled across the Lowton and Golborne primary schools. Births in the corresponding year were not

particularly high and this was not predicted. Birth rates relating to all future intake years are higher and this suggests that additional places are needed in the future in order to provide sufficient flexibility in provision for any newcomer to the area.

3.2.5 Travel and accessibility

No changes are proposed to the school's admission criteria. The school is easily accessible to Lowton residents and will remain so if it moves to the new site.

3.2.6 Whether funding is in place to deliver the proposals

The capital cost of building a new school would be delivered through the Local Education Partnership formed in December 2009 as part of the Building Schools for the Future Programme. The scheme forms part of a new build scheme for Lowton and Golborne High Schools. The capital cost of building the new Lowton J+I School may be directly funded by way of a capital contribution (from land sale) via the PFI contract. This is yet to be determined.

If, when consultation is complete, the proposed new secondary school does not go ahead, Lowton J+I School will be enlarged on its current site. The capital cost of enlarging and refurbishing the current Lowton J+I School would be met through basic need funding.

4 Decision

4.1 Cabinet may approve the proposals; reject them; approve them subject to modification; or approve them subject to meeting a specific condition.

4.2 Cabinet must also provide the main reason for its decision.

5 Recommendation

5.1 It is recommended that Cabinet determines the proposal to enlarge Lowton J+I School by increasing the physical capacity of the school to 210 pupils so that the school admits 30 pupils in each year group.



Proposal to enlarge Lowton J+I School

Notice is given in accordance with section 19(1) of the Education and Inspections Act 2006 that Wigan Council, Children and Young People's Services, Progress House, Westwood Park Drive, Wigan, WN3 4HH intends to make a prescribed alteration to Lowton J+I School (community school), Newton Road, Lowton, WA3 2AW from 01 September 2012.

It is proposed to enlarge Lowton J+I school by rebuilding the premises and increasing the physical capacity of the school to admit more pupils. The proposal is not linked to any other proposal.

It is proposed that the enlarged school be rebuilt on the current site of Lowton Civic Hall, Hesketh Meadow Lane, Lowton, WA3 2AJ as part of a learning campus including a new secondary school proposed for Lowton and Golborne and community facilities. If the proposed new secondary school and learning campus do not go ahead, Lowton J+I School will be enlarged on its current site.

The current capacity of the school is 119 and the proposed capacity will be 210. The current number of pupils registered at the school is 121. The current admission number for the school is 17 and the proposed admission number will be 30 across all year groups from September 2012.

The walking distance between the current Lowton J+I School site and the proposed new site is 0.31 miles so travel arrangements will not be affected.

All applicable statutory requirements to consult in relation to this proposal have been complied with.

This Notice is an extract from the complete proposal. Copies of the complete proposal can be obtained from: Wigan Council, Children and Young People's Services, School Place Commissioning Team, Progress House, Westwood Park Drive, Wigan, WN3 4HH (phone: 01942 486030), email: schoolsforfuture@wigan.gov.uk and on the council website at www.wigan.gov.uk/schoolsforfuture

Within four weeks from the date of publication of these proposals, that is by 11 February 2010, any person may object to or make comments on the proposal by sending them to Wigan Council, Children and Young People's Services, School Place Commissioning Team, Progress House, Westwood Park Drive, Wigan, WN3 4HH or by email to schoolsforfuture@wigan.gov.uk

Signed: Nick Hudson
Executive Director Children and Young People's Services

Publication Date: 14 January 2010



PROPOSALS FOR PRESCRIBED ALTERATIONS OTHER THAN FOUNDATION PROPOSALS: Information to be included in a complete proposal

Extract of Part 1 of Schedule 3 and Part 1 of Schedule 5 to The School Organisation (Prescribed Alterations to Maintained Schools)(England) Regulations 2007 (as amended):

School and local authority details

1. The name, address and category of the school.

Lowton J+I School, Newton Road, Lowton, WA3 2AW

Community primary school.

Implementation and any proposed stages for implementation

2. The date on which the proposals are planned to be implemented, and if they are to be implemented in stages, a description of what is planned for each stage, and the number of stages intended and the dates of each stage.

The proposals are planned to be implemented on 1 September 2012. They will not be implemented in stages.

Objections and comments

3. A statement explaining the procedure for making representations, including
 - (a) the date prescribed in accordance with paragraph 29 of Schedule 3 (GB proposals)/Schedule 5 (LA proposals) of The School Organisation (Prescribed Alterations to Maintained Schools) (England) Regulations 2007 (as amended), by which objections or comments should be sent to the local education authority; and
 - (b) the address of the authority to which objections or comments should be sent.

a) Objections and comments should be sent to the local authority by 11 February 2010.

b) Objections or comments should be sent to:

Wigan Council, Children and Young People's Services, School Place Commissioning Team, Progress House, Westwood Park Drive, Wigan, WN3 4HH or by email to schoolsforfuture@wigan.gov.uk

Alteration description

4. A description of the proposed alteration and in the case of special school proposals, a description of the current special needs provision.

It is proposed to enlarge Lowton J+I School by increasing the physical capacity of the school premises to admit more pupils.

School capacity

5.—(1) Where the alteration is an alteration falling within any of paragraphs 1 to 4, 8, 9 and 12-14 of Schedule 2 (GB proposals)/paragraphs 1-4, 7, 8, 18, 19 and 21 of Schedule 4 (LA proposals) to The School Organisation (Prescribed Alterations to Maintained Schools) (England) Regulations 2007 (as amended), the proposals must also include —

(a) details of the current capacity of the school and, where the proposals will alter the capacity of the school, the proposed capacity of the school after the alteration;

The current physical capacity of the school is 119. The capacity after the alteration will be 210.

(b) details of the current number of pupils admitted to the school in each relevant age group, and where this number is to change, the proposed number of pupils to be admitted in each relevant age group in the first school year in which the proposals will have been implemented;

The current number of pupils admitted to each relevant age group is 17. The proposed number of pupils to be admitted to each relevant year group is 30.

The new admission number will apply from 1 September 2012 across all year groups.

- (c) where it is intended that proposals should be implemented in stages, the number of pupils to be admitted to the school in the first school year in which each stage will have been implemented;

Not applicable.

- (d) where the number of pupils in any relevant age group is lower than the indicated admission number for that relevant age group a statement to this effect and details of the indicated admission number in question.

Not applicable.

(2) Where the alteration is an alteration falling within any of paragraphs 1, 2, 9, 12 and 13 of Schedule 2 (GB proposals) /paragraphs 1, 2, 8, 18 and 19 of Schedule 4 (LA proposals) to The School Organisation (Prescribed Alterations to Maintained Schools) (England) Regulations 2007 (as amended), a statement of the number of pupils at the school at the time of the publication of the proposals.

The number of pupils at the school at the time of publication is:

R	Year 1	Year 2	Year 3	Year 4	Year 5	Year 6	Total
19	17	16	17	16	19	17	121

Implementation

6. Where the proposals relate to a foundation or voluntary controlled school a statement as to whether the proposals are to be implemented by the local education authority or by the governing body, and, if the proposals are to be implemented by both, a statement as to the extent to which they are to be implemented by each body.

Not applicable.

Additional Site

7.—(1) A statement as to whether any new or additional site will be required if proposals are implemented and if so the location of the site if the school is to occupy a split site.

It is proposed that the enlarged school be rebuilt on a new site - the current site of Lowton Civic Hall, Hesketh Meadow Lane, Lowton, WA3 2AJ - as part of a learning campus including a new secondary school proposed for Lowton and Golborne and community facilities. The proposals for the new secondary school are currently under consultation and are subject to new school competition procedures.

However, the proposal to enlarge Lowton J+I School is not dependent on the proposal to establish a new secondary school. If, following consultation, the proposed new secondary school and learning campus do not go ahead, Lowton J+I School will be enlarged on its current site. The current site is of adequate size and no additional site will be required.

(2) Where proposals relate to a foundation or voluntary school a statement as to who will provide any additional site required, together with details of the tenure (freehold or leasehold) on which the site of the school will be held, and if the site is to be held on a lease, details of the proposed lease.

Not applicable.

Changes in boarding arrangements

8.—(1) Where the proposals are for the introduction or removal of boarding provision, or the alteration of existing boarding provision such as is mentioned in paragraph 8 or 21 of Schedule 2 (GB proposals)/7 or 14 of Schedule 4 to The School Organisation (Prescribed Alterations to Maintained Schools) (England) Regulations 2007 (as amended) —

(a) the number of pupils for whom it is intended that boarding provision will be made if the proposals are approved;

Not applicable.

(b) the arrangements for safeguarding the welfare of children at the school;

Not applicable.

- (c) the current number of pupils for whom boarding provision can be made and a description of the boarding provision; and

Not applicable.

- (d) except where the proposals are to introduce boarding provision, a description of the existing boarding provision.

Not applicable.

(2) Where the proposals are for the removal of boarding provisions or an alteration to reduce boarding provision such as is mentioned in paragraph 8 or 21 of Schedule 2 (GB proposals)/7 or 14 of Schedule 4 (LA proposals) to The School Organisation (Prescribed Alterations to Maintained Schools) (England) Regulations 2007 (as amended) —

- (a) the number of pupils for whom boarding provision will be removed if the proposals are approved; and

Not applicable.

- (b) a statement as to the use to which the former boarding accommodation will be put if the proposals are approved.

Not applicable.

Transfer to new site

9. Where the proposals are to transfer a school to a new site the following information—

- (a) the location of the proposed site (including details of whether the school is to occupy a single or split site), and including where appropriate the postal address;

It is proposed that the school occupy a single site located on the current site of Lowton Civic Hall, Hesketh Meadow Lane, Lowton, WA3 2AJ.

If the school does not transfer to the new site (see 7(1) above) it will remain on its current site at Newton Road, Lowton, WA3 2AW.

(b) the distance between the proposed and current site;

The distance between the proposed new site and current site is 0.31 miles.

(c) the reason for the choice of proposed site;

The reasons for the choice of proposed site are as follows:

- It will allow co-location with a new secondary school which will enable: a smooth transition from primary to secondary education; supervised access to specialist facilities which will broaden pupils' educational experience; and the provision of extended and community services for pupils and the wider community.
- It is within a short walking distance of the current site.
- The site is already owned by the council.

(d) the accessibility of the proposed site or sites;

The proposed new site is 0.31 miles from the current school site so will continue to be accessible to existing pupils and the local community.

(e) the proposed arrangements for transport of pupils to the school on its new site; and

Due to the short distance from the existing site, pupils will continue to walk to school or travel by public transport or car if necessary as they do currently.

Numerous bus services utilise Newton Road, passing the current and

proposed school sites. Many bus stops in the area have been upgraded to Quality Bus Corridor standard. This includes those stops on Newton Road near the sites.

- (f) a statement about other sustainable transport alternatives where pupils are not using transport provided, and how car use in the school area will be discouraged.

The new site is well located to take advantage of sustainable travel choices, all of which will be explored in the Travel Plan that will support the site. To assist in sustainable travel choices, many of the residential roads adjacent to the site increase opportunities for walking and cycling, as does the Public Rights of Way Network. There are also many pedestrian links through adjacent residential areas allowing pedestrians to permeate through these areas.

Objectives

- 10.** The objectives of the proposals.

The objectives of the proposal are to enlarge Lowton J+I School by increasing the physical capacity of the buildings from 119 to 210 to:

- ensure that there are sufficient school places to educate primary age children living in the area;
- ensure that there is sufficient flexibility in the system to cater for any unexpected increases in demand for places;
- improve the long term future viability of the school as larger schools have more flexibility and economies of scale within their budgets to deal with any decrease in pupil numbers; and
- address the suitability and condition of the current buildings.

Consultation

11. Evidence of the consultation before the proposals were published including—

- (a) a list of persons who were consulted;
- (b) minutes of all public consultation meetings;
- (c) the views of the persons consulted;

- (d) a statement to the effect that all applicable statutory requirements in relation to the proposals to consult were complied with; and
- (e) copies of all consultation documents and a statement on how these documents were made available.

- (a) A list of persons consulted: appendix 1
- (b) Minutes of all consultation meetings:
 - Staff meeting: appendix 2
 - Governors meeting: appendix 3
 - Open consultation meeting (parents and community): appendix 4
- (c) Details of the views of the persons consulted: appendix 5.
- (d) All applicable statutory requirements to consult in relation to the proposals were complied with as follows:
 - adequate time was allowed: 7 weeks outside school holidays (07 September 2009 to 23 October 2009);
 - sufficient information was provided: in the consultation document, at an open consultation session for parents and the community and at meetings with pupils, staff and governors of the school;
 - it was made clear in the document, on the Wigan Council website and at the open consultation sessions and meetings how consultees could express their views: in writing, by making comments at the meetings or on-line;
 - all the views expressed were presented to the Cabinet of Wigan Council when the decision to publish the proposals was made;
 - all parties specified in school organisation guidance were consulted; and
 - pupils were consulted as part of the original proposal to build a new one and a half form entry primary school on the Lowton Civic Hall site to replace Gilded Hollins and Lowton J+I Schools. It was considered that further consultation on a similar proposal would be confusing to young children.
- (e) The consultation document is attached at appendix 6. Details of how this was made available are included in appendix 1.

Project costs

12. A statement of the estimated total capital cost of the proposals and the breakdown of the costs that are to be met by the governing body, the local education authority, and any other party.

The total capital cost of the new build proposals is approximately £3.9m. This would be delivered through the Local Education Partnership formed in December 2009 as part of the Building Schools for the Future Programme. The scheme forms part of a new build scheme for Lowton and Golborne High Schools. The capital cost of building the new Lowton J+I School may be directly funded by way of a capital contribution (from land sale) via the PFI contract. This is yet to be determined.

If, following consultation, the proposed new secondary school and learning campus do not go ahead, Lowton J+I School will be enlarged on its current site. The capital cost of enlarging and refurbishing the current Lowton J+I School would be approximately £2.5m. This cost would be met through basic need funding.

13. A copy of confirmation from the Secretary of State, local education authority and the Learning and Skills Council for England (as the case may be) that funds will be made available (including costs to cover any necessary site purchase).

A new build school on the site of Lowton Civic Hall forms part of phase one of the Wigan Building Schools for the Future Programme. The local authority will be submitting its Strategy for Change and Outline Business Case for Phase 1 of the Building Schools for the Future programme in the coming months and, subject to the appropriate approvals, will fund the Building Schools for the Future programme in the usual way. The Lowton Civic Hall site is owned by the council

If the proposed new build does not go ahead, Lowton J+I School will be extended on its existing site. This would be funded by the local authority.

Age range

14. Where the proposals relate to a change in age range, the current age range for the school.

Not applicable.

Early years provision

15. Where the proposals are to alter the lower age limit of a mainstream school so that it provides for pupils aged between 2 and 5—

- (a) details of the early years provision, including the number of full-time and part-time pupils, the number and length of sessions in each week, and the services for disabled children that will be offered;

Not applicable.

- (b) how the school will integrate the early years provision with childcare services and how the proposals are consistent with the integration of early years provision for childcare;

Not applicable.

- (c) evidence of parental demand for additional provision of early years provision;

Not applicable.

- (d) assessment of capacity, quality and sustainability of provision in schools and in establishments other than schools who deliver the Early Years Foundation Stage within 3 miles of the school; and

Not applicable.

- (e) reasons why such schools and establishments who have spare capacity cannot make provision for any forecast increase in the number of such provision.

Not applicable.

Changes to sixth form provision

16. (a) Where the proposals are to alter the upper age limit of the school so that the school provides sixth form education or additional sixth form education, a statement of how the proposals will—

- (i) improve the educational or training achievements;

- (ii) increase participation in education or training; and
- (iii) expand the range of educational or training opportunities for 16-19 year olds in the area;

Not applicable.

- (b) A statement as to how the new places will fit within the 16-19 organisation in an area;

Not applicable.

- (c) Evidence —
- (i) of the local collaboration in drawing up the proposals; and
 - (ii) that the proposals are likely to lead to higher standards and better progression at the school;

Not applicable.

- (d) The proposed number of sixth form places to be provided.

Not applicable.

17. Where the proposals are to alter the upper age limit of the school so that the school ceases to provide sixth form education, a statement of the effect on the supply of 16-19 places in the area.

Not applicable.

Special educational needs

18. Where the proposals are to establish or change provision for special educational needs—

(a) a description of the proposed types of learning difficulties in respect of which education will be provided and, where provision for special educational needs already exists, the current type of provision;

Not applicable.

(b) any additional specialist features will be provided;

Not applicable.

(c) the proposed numbers of pupils for which the provision is to be made;

Not applicable.

(d) details of how the provision will be funded;

Not applicable.

(e) a statement as to whether the education will be provided for children with special educational needs who are not registered pupils at the school to which the proposals relate;

Not applicable.

(f) a statement as to whether the expenses of the provision will be met from the school's delegated budget;

Not applicable.

(g) the location of the provision if it is not to be established on the existing site of the school;

Not applicable.

- (h) where the provision will replace existing educational provision for children with special educational needs, a statement as to how the local education authority believes that the new provision is likely to lead to improvement in the standard, quality and range of the educational provision for such children; and

Not applicable.

- (i) the number of places reserved for children with special educational needs, and where this number is to change, the proposed number of such places.

Not applicable.

19. Where the proposals are to discontinue provision for special educational needs—

- (a) details of alternative provision for pupils for whom the provision is currently made;

Not applicable.

- (b) details of the number of pupils for whom provision is made that is recognised by the local education authority as reserved for children with special educational needs during each of the 4 school years preceding the current school year;

Not applicable.

- (c) details of provision made outside the area of the local education authority for pupils whose needs will not be able to be met in the area of the authority as a result of the discontinuance of the provision; and

Not applicable.

- (d) a statement as to how the proposer believes that the proposals are likely to lead to improvement in the standard, quality and range of the educational provision for such children.

Not applicable.

20. Where the proposals will lead to alternative provision for children with special educational needs, as a result of the establishment, alteration or discontinuance of existing provision, the specific educational benefits that will flow from the proposals in terms of—

- (a) improved access to education and associated services including the curriculum, wider school activities, facilities and equipment with reference to the local education authority's Accessibility Strategy;
- (b) improved access to specialist staff, both educational and other professionals, including any external support and outreach services;
- (c) improved access to suitable accommodation; and
- (d) improved supply of suitable places.

Not applicable.

Sex of pupils

21. Where the proposals are to make an alteration to provide that a school which was an establishment which admitted pupils of one sex only becomes an establishment which admits pupils of both sexes—

- (a) details of the likely effect which the alteration will have on the balance of the provision of single sex-education in the area;

Not applicable.

- (b) evidence of local demand for single-sex education; and

Not applicable.

- (c) details of any transitional period which the body making the proposals wishes specified in a transitional exemption order (within the meaning of section 27 of the Sex Discrimination Act 1975).

Not applicable.

22. Where the proposals are to make an alteration to a school to provide that a school which was an establishment which admitted pupils of both sexes becomes an establishment which admits pupils of one sex only—

- (a) details of the likely effect which the alteration will have on the balance of the provision of single-sex education in the area; and

Not applicable.

- (b) evidence of local demand for single-sex education.

Not applicable.

Extended services

23. If the proposed alterations affect the provision of the school’s extended services, details of the current extended services the school is offering and details of any proposed change as a result of the alterations.

Lowton J+ I Primary School provides access to extended services through the council’s cluster model.

A breakfast club and some after-school activities are currently available at the school. Pupils can also access activities at other schools in the cluster.

As a minimum the new school will provide access to each of the five areas of the ‘core offer’ to be delivered through the council’s existing cluster model. The new school would also aim to build upon and enhance provision above the core offer. This will be facilitated by the design of the new building and the greater flexibilities in staffing which would be available at a larger school because of the budget. Co-location with a secondary school and community facilities on a learning campus will also increase

opportunities for extended school provision.

Need or demand for additional places

24. If the proposals involve adding places—

- (a) a statement and supporting evidence of the need or demand for the particular places in the area;

For September 2009, all reception class places in the Lowton area primary schools are full.

Birth statistics for the Lowton area suggest that this situation will continue for the foreseeable future:

Birth year	2004/05	2005/06	2006/07	2007/08	2008/09
Year enters Reception	2009/10	2010/11	2011/12	2012/13	2013/14
No: of births	121	140	128	124	142

The provision of an additional 17 places per year group at Lowton J+I School will help ensure that school age children living in Lowton can access a school place locally. It will also provide sufficient flexibility in the system to cater for any unexpected increases in demand.

- (b) where the school has a religious character, a statement and supporting evidence of the demand in the area for education in accordance with the tenets of the religion or religious denomination;

Not applicable.

- (c) where the school adheres to a particular philosophy, evidence of the demand for education in accordance with the philosophy in question and any associated change to the admission arrangements for the school.

Not applicable.

25. If the proposals involve removing places—

- (a) a statement and supporting evidence of the reasons for the removal, including an assessment of the impact on parental choice; and

Not applicable.

- (b) a statement on the local capacity to accommodate displaced pupils.

Not applicable.

Expansion of successful and popular schools

25A. (1) Proposals must include a statement of whether the proposer considers that the presumption for the expansion of successful and popular schools should apply and, where the governing body considers the presumption applies, evidence to support this.

(2) Sub-paragraph (1) applies to expansion proposals in respect of primary and secondary schools, (except for grammar schools), i.e. falling within:

(a) (for proposals published by the governing body) paragraph 1 of Part 1 to Schedule 2 or paragraph 12 of Part 2 to Schedule 2;

(b) (for proposals published by the LA) paragraph 1 of Part 1 to Schedule 4 or 18 of Part 4 to Schedule 4

of the School Organisation (Prescribed Alterations to Maintained Schools) (England) Regulations 2007 (as amended).

Not applicable.

List of those consulted at Stage 1 and the ways in which the consultation document was made available to them

Consultee	Way in which consultation document was made available
The local authority	Copies were distributed to all elected members via the council's internal mail system.
Staff of Lowton J+I School	The headteacher distributed copies to all members of staff.
Governors of Lowton J+I School	Copies were posted to governors' home addresses.
Parents of pupils currently attending Lowton J+I School	A copy was sent to each family by 'pupil post'.
Parents of pre-school children in the area	A number of copies were sent to nurseries in the area (local authority nurseries and voluntary and private providers) and managers asked to place them where they would be accessible to parents and staff.
Staff and governing bodies of other schools in the area: <ul style="list-style-type: none"> • Lowton West • St Luke's C E • Lowton St Mary's C E • St Catharine's Catholic • Leigh Gilded Hollins • Lowton High School • Golborne High School 	A number of copies were sent to the schools and the headteachers asked to give one to the chair of governors and to place the remainder where they would be accessible to parents and staff.
MP for the area	A copy was posted.
Trade Unions and other professional associations.	Copies were posted.
Local Diocesan authorities	Copies were posted.
Other members of the community	Copies of the document were made available at: <ul style="list-style-type: none"> • Leigh town hall • Leigh library • Wigan town hall • Church Lane Community Centre • Children and Young People's Services reception

Consultation on Wigan Schools for the Future - Phase 1

Stage 1: Consultation on the enlargement and relocation of Lowton Junior and Infant School

Meeting: Members of Staff of Lowton J & I Primary School
Date: 01 October 2009
Time: 4 pm

Present: 11 Members of staff
A number of officers from Wigan Council

Proposal to enlarge and relocate Lowton Junior and Infant School

This is likely to be the first of a series of meetings that we will be holding with school.

Introduction:

The new proposal is that Lowton J + I be rebuilt and co-located with the new secondary school on the Lowton Civic Hall site and that a new admission number of 30 (210 pupils in total) will apply to Reception from September 2012 and across all year groups when the new premises are occupied.

In May and June this year, we consulted parents, staff, governors and the wider community on Wigan Council's proposals for phase 1 of Building Schools for the Future. This proposal replaces the original proposal to close two schools and replaced with a 1.5 fe school co-located on the proposed Golborne / Lowton High School. Cabinet listened to everything that people said, and read everything that they had written throughout the consultation exercise and the decision was made to withdraw Gilded Hollins from the consultation.

New Proposals:

- For September 2009, all reception class places in the Lowton area primary schools are full. Birth statistics suggest that this situation will continue for the foreseeable future and the Council must ensure that there are enough school places to educate school age children living in the locality. By enlarging Lowton J & I to take an additional 13 pupils per year group, this will provide sufficient flexibility in the system to cater for any unexpected increased in demand.
- Lowton J + I is currently a very small school with 118 pupils on roll in 2008/09. The policy of the Council is to have primary schools with at least 210 pupils on roll so that they have flexibilities and economies of scale within their budgets to deal with decreasing pupil numbers. By providing the additional school places needed in the Lowton area at Lowton J + I it secures the school's long term viability and future.
- The Lowton J + I school buildings are not ideal for the delivery of the modern curriculum and condition issues are inherent to the original build quality and design.

The proposal will enable to school and its pupils to build on this success by:

- Providing newly built premises that are appropriate for the delivery of the modern curriculum;
- Co-locating with a Children's Centre and a new secondary school that will enable a smooth transition from pre-school to reception and from Y6 in primary to Y7 in secondary;
- Enabling supervised access to specialist facilities in the secondary school that will actively engage pupils in learning and broaden the educational experience;
- Providing extended and community services for pupils, parents and the wider community.

Strict legal procedures have to be followed to enlarge schools.

The timescale for consultation on the new proposal to expand Lowton J + I school remains in line with the competition to run the new Lowton / Golborne High school and to close the existing high schools.

In response to the presentation and information given, members of staff were given the opportunity to ask questions:

- Q. Who will be responsible for the staffing structure of the new school?
- A. The head teacher and governors will decide the staffing structure of the new school. There are more opportunities for current members of staff through expansion and the need for additional members of staff.
- Q. What happens if the organisation who is bidding to run the new school does not want to include the co-location of services or the design of the new school?
- A. Cabinet will look at the potential organisations that put in a bid; they are only likely to be successful if they are adhering to a stringent set of criteria. If the organisation does not, then Cabinet will not agree to their running of the school.
- Q. In terms of staffing, the school currently has four vertically grouped classes. What will happen when we admit more and more children? Will we be expected to keep admitting the pupils until the new school is built?
- S. We currently have 126 children on roll with a limit of 119. We have one class of 36 children.
- A. The capacity of the new school will be 210. The admission number then will be 30, so there will eventually be 7 classes. Once the new school is built, the admission number of 30 will apply across all year groups so children will have to be admitted up to that number on demand. The staffing structure will need to be flexible and reviewed regularly.
- Q. What happens if there is a change in government? Would the build go ahead?
- A. Yes. We are consulting on the enlargement of Lowton J & I and have funding in place to do this on the current site should the proposal for the build of the Golborne / Lowton High School not go ahead on the site of Lowton Civic Hall.
- Q. The issues surrounding the village green, what will happen?

- A. This is going through the statutory consultation process.
- S. I have visited a school in Culcheth where the design has included large open flexible spaces that would be a wonderful place in which to work.
- S. Disappointment that the school has not signed up to the idea of the Children's Centre.
- S. Current early years provision is sufficient in the area, however, as future demand increases; provision will also need to increase.
- Q. What will happen to this building when the new building is ready?
- A. One way the Council obtains additional funding is through the sale of land. We will need to look into this before a final decision can be made.

Meeting ended 5pm.

Consultation on Wigan Schools for the Future - Phase 1

Stage 1: Consultation on the enlargement and relocation of Lowton Junior and Infant School

Meeting: Governors of Lowton J & I Primary School
Date: 01 October 2009
Time: 5pm

Present: 5 Governors
Head Teacher
A number of officers from Wigan Council

Proposal to enlarge and relocate Lowton Junior and Infant School

This is likely to be the first of a series of meetings that we will be holding with school.

Introduction:

The new proposal is that Lowton J + I be rebuilt and co-located with the new secondary school on the Lowton Civic Hall site and that a new admission number of 30 (210 pupils in total) will apply to Reception from September 2012 and across all year groups when the new premises are occupied.

In May and June this year, we consulted parents, staff, governors and the wider community on Wigan Council's proposals for phase 1 of Building Schools for the Future. This proposal replaces the original proposal to close two schools and replaced with a 1.5 fe school co-located on the proposed Golborne / Lowton High School. Cabinet listened to everything that people said, and read everything that they had written throughout the consultation exercise and the decision was made to withdraw Gilded Hollins from the consultation.

New Proposals:

- For September 2009, all reception class places in the Lowton area primary schools are full. Birth statistics suggest that this situation will continue for the foreseeable future and the Council must ensure that there are enough school places to educate school age children living in the locality. By enlarging Lowton J & I to take an additional 13 pupils per year group, this will provide sufficient flexibility in the system to cater for any unexpected increased in demand.
- Lowton J + I is currently a very small school with 118 pupils on roll in 2008/09. The policy of the Council is to have primary schools with at least 210 pupils on roll so that they have flexibilities and economies of scale within their budgets to deal with decreasing pupil numbers. By providing the additional school places needed in the Lowton area at Lowton J + I it secures the school's long term viability and future.
- The Lowton J + I school buildings are not ideal for the delivery of the modern curriculum and condition issues are inherent to the original build quality and design.

The proposal will enable to school and its pupils to build on this success by:

- Providing newly built premises that are appropriate for the delivery of the modern curriculum;
- Co-locating with a Children's Centre and a new secondary school that will enable a smooth transition from pre-school to reception and from Y6 in primary to Y7 in secondary;
- Enabling supervised access to specialist facilities in the secondary school that will actively engage pupils in learning and broaden the educational experience;
- Providing extended and community services for pupils, parents and the wider community.

The timescale for consultation on the new proposal to expand Lowton J + I school remains in line with the competition to run the new Lowton / Golborne High school and to close the existing high schools.

In response to the presentation and information given, governors were given the opportunity to ask questions:

- S. The governing body wishes to express their desire for the proposal to enlarge and relocate Lowton J + I to go ahead. The governors are enthusiastic about the opportunities that the proposal presents and considers that it will be hugely beneficial for pupils and staff.
- S. There were a number of instances during the consultation period on the initial proposal to discontinue Lowton J + I and Gilded Hollins primary schools, where 'Save Our School' campaigners made detrimental remarks in respect of the proposed merger of the two schools. The governing body wants this new proposal to go ahead and considers that the majority of parents are in favour of it. It does not wish any negative campaign from a small group of individuals to stop the proposals going ahead.

Meeting ended at 6pm.

Consultation on Wigan Schools for the Future - Phase 1

Stage 1: Consultation on the enlargement and relocation of Lowton Junior and Infant School

Meeting:	Lowton J & I Primary School – Open consultation session
Date:	01 October 2009
Time:	6pm
Present:	A number of officers from Wigan Council
Sessions attended:	A total of 4 sessions were attended

Proposal to enlarge and relocate Lowton Junior and Infant School

Local Resident:

- Transition period and disruption to learners.
- How will disruption be kept to a minimum?
- Separation of primary and secondary provision.
- Primary class sizes; will they increase?
- Access to the new site, what is being considered?
- Environmental survey and results; why the delay?
- Residents' consultations – evening date, what is the date?

Local Resident x3:

- Current class sizes and what will the class sizes be?
- What would the exclusion policy be for a new combined school?
- Traffic to new site, there is an obvious problem, what are we doing about this?
- Loss of playing fields. What will be put in their place?
- What will the cost be to line new fields, more than now?
- Will the playing fields be flood-lit?
- Eccles Old Road PFI school appears to be overly security conscious, will the same apply here? We want a pleasant, environmental school, not like a prison.
- Will there be retention of facilities currently available at Lowton Civic Hall?
- What if Laing O'Rourke goes bust, who operates the school?
- The Women's Institute has concerns over 'park' facilities on site, are there going to be any? There is nowhere local to take children.
- A 25k donation was given many years ago by Bovis home builders, what happened to this?
- Public footpaths, are they going to be retained? There are no public footpaths.
- Perimeter fencing, what plans do we have for location?
- Is there a possibility of retaining footpaths at some point?

Local Resident:

- Why has the Council opted to go down this route (expense) without first going to consultation?
- Why knock down two good schools for one?
- Why not build on existing Golborne High site?
- Will Civic Hall facilities be kept in the school?
- How will current roads cope with the increased traffic?
- There will be increased behaviour problems in a larger school.
- What effect will the two year period have on standards?
- PFI – what cost does this put on Wigan tax payers.
- If things don't work with the successful bidder, what process do we have to correct this?
- Why can't a modern curriculum be delivered in the existing schools?
- What will a change in government bring to PFI bids? Will it be a 'white elephant' like Leigh Sports Village?
- Will the increased numbers of pupils be safe from traffic?
- Will there be provision for pupils to cycle to the new school?
- Why are there no plans available yet?
- How many people have responded to advertisement for bidders?
- When will we know who is going to run the school?
- Concerns over mixed ages on one site.

Parent:

- Good news in one sense.
- Concerned over staff casualties.
- Traffic concerns, what measure are taking place to ease this?
- Where will the site access be?
- What facilities will be on site?
- Where will additional primary pupils come from to fill the new larger primary school?
- Will there be an automatic entry from primary to the new secondary school?
- Should the Lowton Civic proposal not go ahead, what happens to Lowton J & I?
- What does the bid process mean?

Appendix 5

Consultation on the proposal to enlarge and relocate Lowton J & I primary school

Stage 1 consultation 07 September 2009 to 23 October 2009

A total of 21 questionnaires were received on the consultation on the enlargement and relocation of Lowton J and I primary school.

Type of respondent	Number of respondents
Parents of Lowton J & I pupils	9
Staff at Lowton J & I	9
Governor at Lowton J & I	2
Other	1
Total	21

Questions	Yes	No	Not Stated	Respondents
Do you think that the booklet clearly explains why we are proposing to enlarge Lowton J & I?	20	1 (Other)		9 Staff 9 Parents 2 Governors 1 Other
Do you understand how and when to make your views known?	21			9 Staff 9 Parents 2 Governors 1 Other
Do you think that Lowton J & I should be enlarged to take a maximum of 30 children per year group?	20	1 (Other)		9 Staff 9 Parents 2 Governors 1 Other
Do you agree that locating primary and secondary schools together, with separate access points, aids transisition and educational outcomes?	18	2 (2 parents)	1 (parent)	9 Staff 9 Parents 2 Governors 1 Other

A number of positive comments were received from the respondents that agree with the proposal these are listed below:

- enlarging the intake will ensure the schools future
- purpose built building for modern curriculum
- the school is well run and has a strong learning ethos and will thrive in new circumstances allowing more children to access what the school has to offer
- fantastic opportunity to have a new building and facilities
- enhance the strong links with Lowton High School
- proposal will benefit families and their children

Appendix 5

- proposal must be considered as part of the bigger picture alongside the secondary school proposal
- exciting future for Lowton J & I
- fantastic opportunity

A number of concerns were received from the parents of Lowton J & I, these are listed below:

- traffic congestion, transport links and access to the site
- co-location of primary and secondary schools

Alternative suggestion

An alternative suggestion to retain Lowton J & I and extend the building was suggested by 2 parents of Lowton J & I pupils.

Wigan **schools** for the future

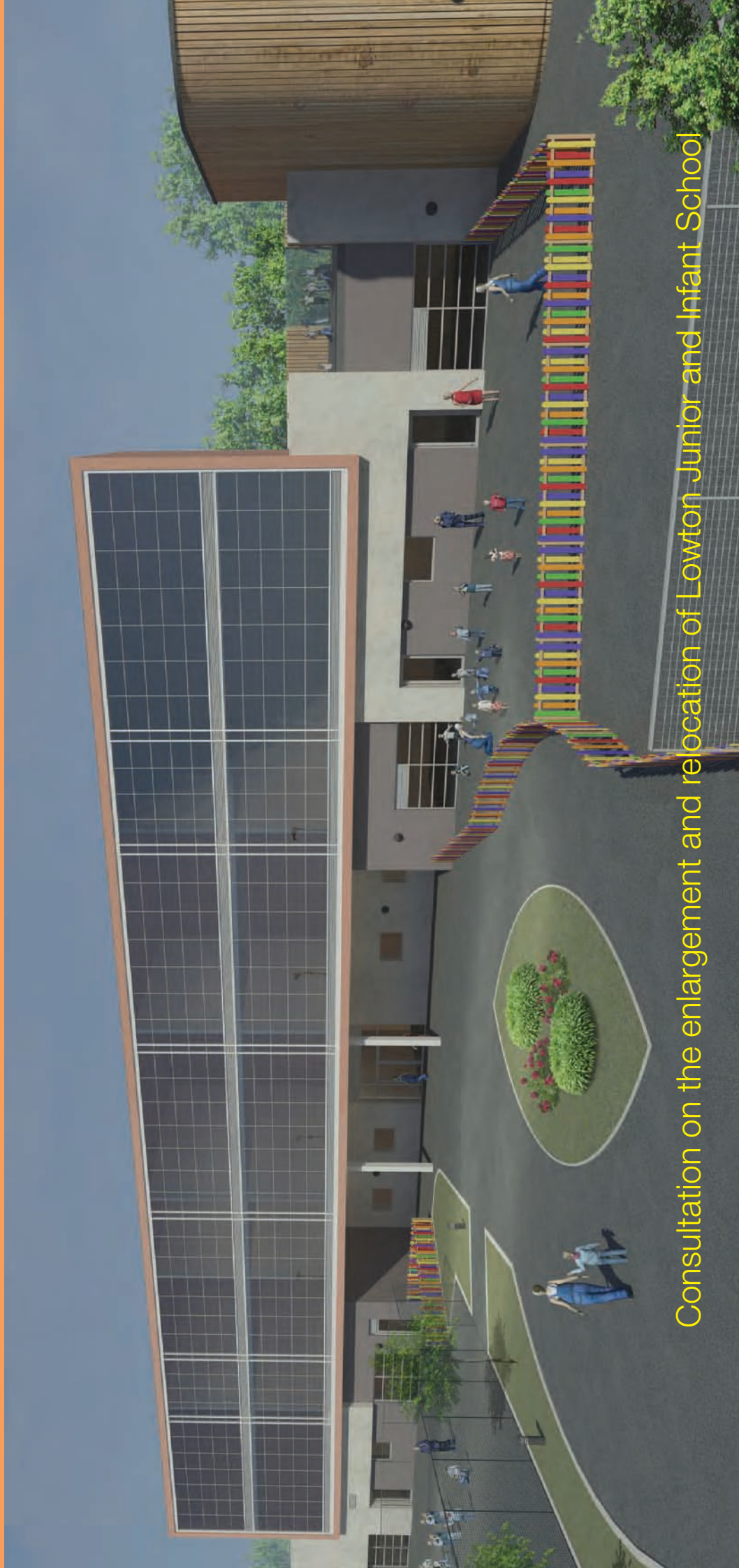

Consultation on the enlargement and relocation of Lowton Junior and Infant School

SEPTEMBER 2009

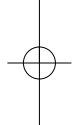

“Education is for improving the lives of others and for leaving your community and world better than you found it” .

Marian Wright Edelman

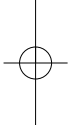
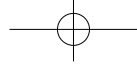
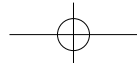

Foreword

In May and June this year, we consulted parents, staff, governors and the wider community on Wigan Council's proposals for phase 1 of Building Schools for the Future.

The Council is committed to providing children and young people of the borough with the best start in life, the best education and the very best opportunities for the future. The proposals we put forward in May and June represented our strategy for achieving this vision.

As promised, we have listened to everything that people have said, and read everything that people have written, throughout the consultation exercise. We have had to balance people's views against our educational vision and the need for Wigan to be part of the transformational changes taking place right across the country, so that our children and young people are equipped for the future. By taking this approach, the Council has decided on the next steps for each proposal.

For primary education in Lowton, the Council has decided to withdraw its original proposal and replace it with an alternative one that still allows the educational vision to be achieved whilst acknowledging the responses to the earlier proposal.

Please take time to read the document and let us know what you think about this new proposal.



Councillor Susan Loudon
Cabinet Champion for Children and Young People

Our vision for the future

Our vision for the future and specific proposals for phase one of Building Schools for the Future was articulated in the consultation document entitled 'Wigan Schools for the Future: our vision for education in Wigan' published in May 2009. This is still available on the Wigan Council web site at

www.wigan.gov.uk/Services/EducationLearning/Schools/SchoolsFuture/Downloads.htm

and you can obtain a hard copy by contacting the Council at the address or telephone number given on page 10.

In brief, our vision is to provide a world class education for all children and young people of the borough where children are encouraged to achieve to the best of their ability, starting with early years through to secondary school age and beyond.



Learning Campus for Lowton and Golborne

The Department for Children, Schools and Families is actively encouraging Councils to develop a co-location approach to future education developments in order to ease the transition between the different phases of education and to provide a fully integrated educational experience for children and young people.

Through the Building Schools for the Future programme we have an exciting opportunity to transform education provision for the Lowton and Golborne communities through the co-location of schools and services. Our proposal is to build a brand new, state of the art learning campus for those aged between 0 – 16 on the Lowton Civic Site. The campus will consist of:

- a new secondary school for students aged 11 – 16;
- a new primary school for children aged 4 – 11;
- a Children's Centre for infants and children aged 0 – 4; and
- community and leisure facilities.

The proposal is progressing, with the Council having recently published competition proposals for the new secondary school to replace Lowton and Golborne High Schools. The Council expects to take a decision on the secondary school proposals by mid March 2010.

However, the proposal to discontinue both Lowton J + I and Leigh Gilded Hollins Primary Schools and establish a new primary school on the same site has been withdrawn after considering the views of those consulted.



New Proposal for Primary School Provision

The Council is now consulting on a new proposal:

To enlarge Lowton J + I from September 2012.

It is proposed that Lowton J + I be rebuilt and co-located with the new secondary school on the Lowton Civic Hall site and that a new admission number of 30 (210 pupils in total) will apply across all year groups of the school from September 2012. A map showing the current location of Lowton J + I Infant School and the proposed new site is on the next page.

The new proposal addresses the following issues:

- For September 2009, all reception class places in the Lowton area primary schools are full. Birth statistics suggest that this situation will continue for the foreseeable future and the Council must ensure that there are enough school places to educate school age children living in the locality. By enlarging Lowton J + I to take an additional 13 pupils per year group, this will provide sufficient flexibility in the system to cater for any unexpected increases in demand.

- Lowton J + I is currently a very small school with 118 pupils on roll in 2008/09. The policy of the Council is to have primary schools with at least 210 pupils on roll so that they have flexibilities and economies of scale within their budgets to deal with decreasing pupil numbers. By providing the additional school places needed in the Lowton area at Lowton J + I it secures the school's long term viability and future.
- The Lowton J + I school buildings are not ideal for the delivery of the modern curriculum and condition issues are inherent to the original build quality and design.



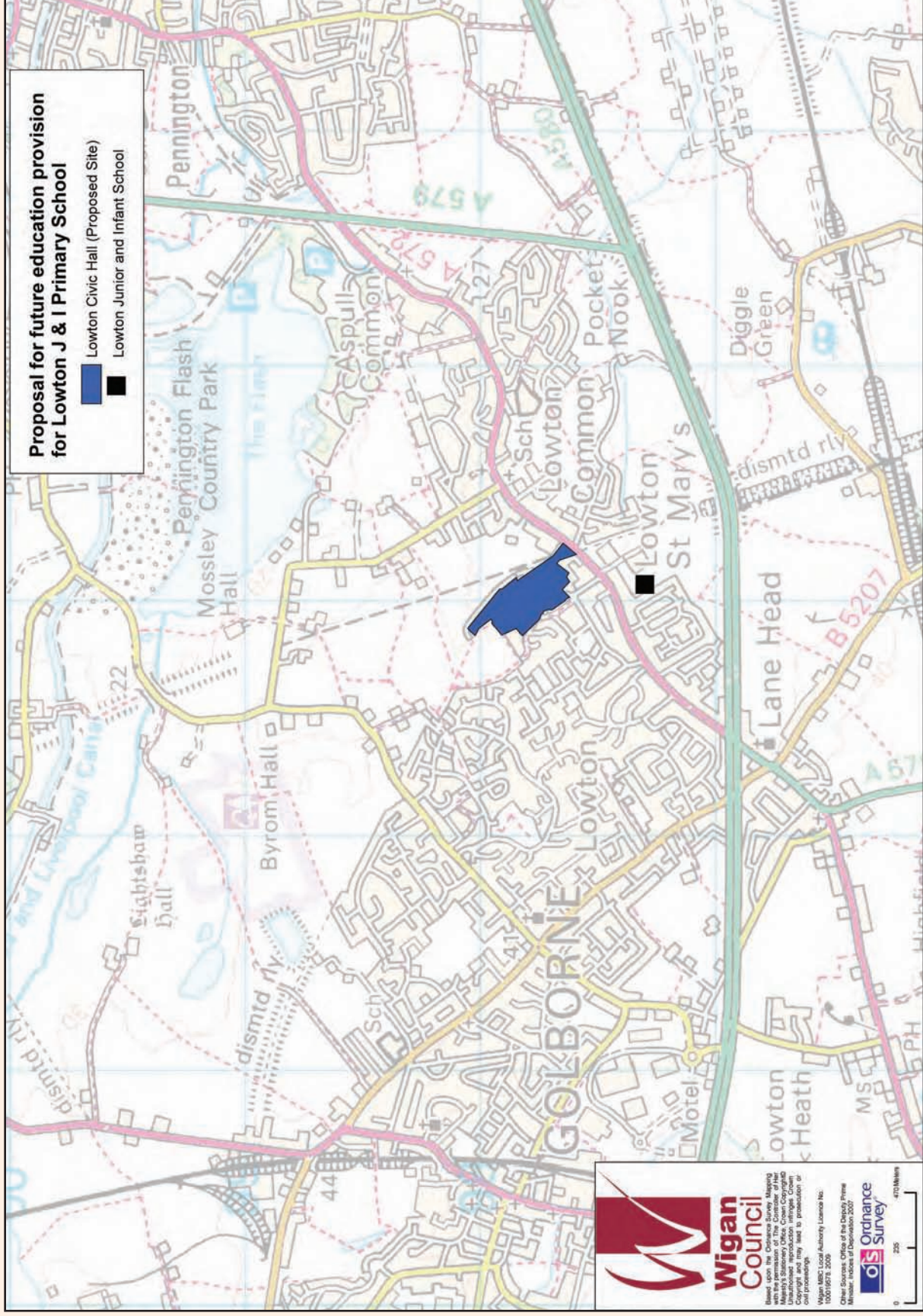

OFSTED (the organisation that assesses and reports on school performance) says that Lowton J + I is a very happy school where pupils' academic achievement overall is satisfactory and many outcomes are good.

The proposal will enable the school and its pupils to build on this success by:

- providing newly built premises that are appropriate for the delivery of the modern curriculum;
- co-locating with a Children's Centre and a new secondary school that will enable a smooth transition from pre-school to reception and from Y6 in primary to Y7 in secondary;
- enabling supervised access to specialist facilities in the secondary school that will actively engage pupils in learning and broaden the educational experience;
- providing extended and community services for pupils, parents and the wider community.

What this means for you and your child

Schools receive funding mainly according to how many children are on roll. Therefore, a larger school can have the same, and sometimes smaller, class sizes as smaller schools, due to economies of scale. The headteacher and governors will decide on class organisation in the enlarged school but the law requires that class sizes can be no more than 30 pupils in Reception, Y1 and Y2.

Children currently in years 4, 5 and 6 will continue in the current premises of Lowton J + I. Children in reception to year 3 will automatically move to the school's new premises in September 2012 – there will be no need for parents to apply for a place.

The campus will be designed to maximise the safety and security of all children. The primary school will have its own access points and play areas and the primary school and secondary school governing bodies will consider, in consultation with parents, issues such as the timing of the school day for different age groups.

How you can make your views known:

Meeting	Date, time and venue	Who should attend
Meeting for staff	Date: 1st October Time: 4pm Venue: Lowton J + I	All staff of Lowton J + I
Meeting for governors	Date: 1st October Time: 5pm Venue: Lowton J + I	All governors of Lowton J + I
Open consultation sessions	Date: 1st October Time: 6pm to 8.30pm Venue: Lowton J + I Newton Rd Lowton Warrington WA3 2AW	These sessions are open to everyone but especially to parents of pupils attending Lowton J + I and parents who wish their children to attend Lowton J + I in the future. If you wish to attend one of these sessions, please contact Lowton J + I either in person or by telephone (01942 673213) and you will be allocated a time to attend.

You can also make your views known by writing to or emailing the address on page 10, or by completing and returning the questionnaire at the end of this booklet. The questionnaire can also be completed and returned on-line at www.wigan.gov.uk/schoolsforfuture.

Whichever method you choose, you should return your comments no later than **23 October 2009**.

Consultation process

This consultation is stage 1 of the consultation process required in order to enlarge a school. The information provided in the booklet and at the consultation sessions is intended to be sufficient in order for people to form a view on the proposal, in principle. However, the Council has not, at this stage, worked out every detail of the proposal as it needs to listen to views and concerns so that the detailed proposals, supplied later in the process, can take these into account.

This consultation is primarily concerned with the educational elements of the proposal to enlarge Lowton J + I. School Organisation Regulations do not require the Council to consult on the relocation of the school and Cabinet may choose to disregard any comments made about the location of the school during this stage of the consultation process. Residents and members of the community will be consulted on the proposed location of the school as part of the planning application process at a later date and their views will be reported back to Council.

Due to the volume of responses received during school reorganisation consultation exercises, the Council will not be able to acknowledge written responses nor enter into correspondence with interested parties during or after the consultation period. It is important to attend the relevant

consultation event if you require clarification or more information on the proposal. If, during the course of consultation, it becomes clear that there are a number of frequently asked questions that are material to people being able to form a view on the proposal, these will be posted, together with the answers, on to the Council website at www.wigan.gov.uk/Services/EducationLearning/Schools/SchoolsFuture/WSFConsultation.htm

Those without access to the internet will be sent a hard copy of any frequently asked questions and answers, on request.

Please note that all responses sent in response to this consultation exercise will be made available to Elected Members for decision making purposes.



Next steps

Strict legal procedures have to be followed to enlarge schools. A timetable of events is shown below which includes periods of consultation and dates when decisions are expected to be taken. If you make your views known outside of these periods, or in any other way than described, they cannot be taken into account.

Event	Dates
Consultation – during this time you can make your views known by <ul style="list-style-type: none"> • attending the open consultation sessions (notes will be taken) • writing to or emailing the Council or • completing the response form at the end of this booklet. The address to write or e-mail to is provided on page 10.	Monday 7 September to Friday 23 October 2009
Results of the consultation will go to the Cabinet of the Council. Cabinet will decide whether it wishes to proceed with the proposals.	December 2009
Representation period – Statutory notices are published. These are public notices that appear in the local newspaper, at the entrances to the school and in another public place in the area, such as a community centre or library. You can make your views known at this stage by writing to the local authority at the address on page 10. The address and date by which written comments must be received will also be given in the public notice.	Four weeks during January and February 2010.
The Local Authority makes the final decision on the proposal*	March 2010
School is rebuilt and enlarged on the new site	September 2012

* The following can appeal against the Local Authority's decision: the Liverpool Church of England Diocese; the Bishop of the Liverpool Roman Catholic Diocese; and the governors of Lowton J + I. Please note that the timetable may alter. The Local Authority or the staff at Lowton J + I will be able to tell you if this happens and let you know of the new dates the Council is working towards.

Circulation List

We have already held extensive consultations with representatives from schools; local elected members and other interested parties on our vision for future education in Wigan and proposals in relation to individual schools. As part of this consultation exercise we are consulting the following:

- Parents of children attending Lowton J + I;
- Pupils at Lowton J + I;
- Governors and staff of Lowton J + I;
- Diocesan Authorities;
- Other primary schools in the area;
- Trade Unions and Professional Associations;
- Elected Members (Councillors);
- The Local Member of Parliament;
- Neighbouring Authorities;
- The local community (via web site, placing of document in the local library, and early years settings), and
- Voluntary groups that use the school premises.

Address for correspondence

Wigan Council
 Children and Young People's Services
 School Place Commissioning Team
 Progress House
 Westwood Park Drive
 Wigan
 WN3 4HH

Phone: 01942 486028 or 01942 486029

Email: SchoolsForFuture@wigan.gov.uk

We can make this information available in other formats and languages on request. Contact details as above.



Consultation response form on the enlargement of Lowton J + I

Response form

Please read the booklet carefully before making your response below. Please place an x in the box that most closely describes your views.

1 Do you think that the booklet clearly explains why we are proposing to enlarge Lowton J + I?

Yes No Don't know

2 Do you understand how and when to make your views known?

Yes No

3 Do you think that Lowton J + I should be enlarged to take a maximum of 30 children per year group?

Yes No

4 If you think that the school should **NOT** be enlarged, please state below why you think this.

5 Do you agree that locating primary and secondary schools together, with separate access points, aids transition and educational outcomes ?

Yes No

6 If you do not agree that co-location will aid educational outcomes please state below why you think this:

7 Please write any other comments you may have about the proposal below:



8 If you are planning to attend a drop-in session, do you need special assistance with:

Access Yes No

Interpreter Yes No

If you answered YES, please write your name, address and telephone number below so we can contact you about these requirements.

A Member of the community
Other

Please provide your name and address below (this information is for identification purposes only and will not be shared beyond the Council)

9. Are you

A parent or guardian of a child that attends Lowton J + I

A parent or guardian of a pre-school age child that you wish to attend Lowton J + I in the future?

A member of staff at Lowton J + I?

A Governor at Lowton J + I?

Please return your completed form no later than Friday 23 October 2009 to:

Wigan Council
Children and Young People's Services
School Places Commissioning Team
Progress House
Westwood Park Drive
Wigan
WN3 4HH

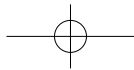
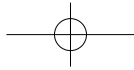

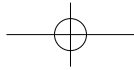
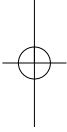



Lowton St. Mary's C. E. Primary School, (School 359)

Newton Road, Lowton St. Mary's,
Nr. Warrington, WA3 1EW
Telephone: 01942 769710
www.lowtonsaintmarys.wigan.sch.uk

Headteacher: Mrs L. C. Baker, B.Ed.(Hons), N.P.Q.II

11th February, 2010

To Whom it may Concern

Proposal to enlarge Lowton J & I School

The Governing Body of Lowton St. Mary's C.E. Primary School wish to object strongly to the proposals to enlarge Lowton J & I School from 17 to 30 on the following grounds:

- We feel there is sufficient capacity within existing Lowton Primary Schools to meet the community needs. If any increase was necessary this would need to be only minor, perhaps to 20 places, rather than 30.
- 39% of children attending Lowton St. Mary's C.E. Primary School live in the Lowton J & I catchment area and if that School were to extend its intake to 30, the roll of St. Mary's would fall, making our School very vulnerable.
- We feel this proposal to be the deliberate intention of Wigan LA
- The LA has argued that two local high schools are to close due to *over* capacity – *if* the birth rate is rising by such an extent, then *more* high school places would be needed, not fewer.
- We note that the proposed new building for Lowton J & I School is large enough for 1½ form entry, yet the proposal is for only 1 FE.
- What would the additional space be used for?
- On page 6 of the emailed document received in school on 21st January, at para (c) the last phrase of the first bullet point refers to "and the provision of extended and community services for pupils and the wider community".
- We have been led to believe that St. Mary's C.E. Primary School was the preferred option to provide extended and community services for the community

- In appendix 1 it states that Staff and Governing Bodies of other schools (including Lowton St. Mary's C.E. Primary School) had been consulted.
- We disagree with this statement. To our knowledge the School has received only one email regarding this specific proposal and that is the one received on 21st January (although dated 14th January) from Samantha Doran.
- No copies of a consultation document concerning the specific enlargement of Lowton J & I School have been received in School - or Nursery.
- In Appendix 2 - second bullet point reference is made to "co-locating with a Children's Centre and a new secondary school that will enable a smooth transition from pre-school to reception and ..."
- We have recently provided, with the support of the Diocese and LA, a brand new, purpose-built facility at our school for children of pre-school age.
- Why is there need for two in the Lowton area?

The Governing Body wish to register their strong opposition to the proposal to enlarge Lowton J & I School from 17 to 30.

L. C. BAKER

Headteacher

EDITH SMITH

Chair of Governors